

Brewer's Cemetery

Compiled by
Joseph C Dangler and Robert L White
March 2001

This cemetery is on Route 524 about one mile north of Route 195 between Farmingdale and Squankum New Jersey. It is a very old cemetery believed to be in use prior to 1768.

The cemetery probably includes many more unmarked graves, unidentified at present. The ground is very uneven and only the most prominent unmarked graves, mounds and hollows were recorded, a few trees were recorded for reference. All graves were recorded and pictures were made of selected graves and are on file at Monmouth County Historical Association, Freehold New Jersey.

This cemetery had been recorded many times in the past with various results. Therefore we decided to record the cemetery as it is today, and add other records we were aware of on the burials in this cemetery.

The cemetery was divided into 16 squares, 12 of which were 50' by 50' and 4 were 50' by 58.5', which were lettered. Each of these areas were then divided into 10' by 10' square feet blocks except 4 blocks in areas N thru Q which each have an additional square 10' by 8.5'. All graves were then recorded including fieldstones, wooden slabs, areas that were certainly graves. And the mounds and hollows as previously mentioned. The results for each grave were then recorded by area and the other records were added.

Codes were used in recording the cemetery as follows;

T= tree

H= Hollow

M= Mound

A Number= a grave

F.S.= Footstone

UNK= is used in most instances where a grave is present but not identifiable

W.S.= wooden slab marker on grave

Brewer's Cemetery

Compiled by
Joseph C Dangler & Robert L White
March 2001

This is the present data on each grave in the diagram attached by area and grave number.

AREA A

No Graves found in this area

AREA B

Grave 1

Marks, Richard G*

Wife Sarah, daughter of William and Elizabeth Riddle, b. Nov. 28, 1834 d. Jan. 5, 1888.

Stone broken and top marked "Mother".

Grave 2

Riddle, John H, b. Apr. 7, 1843 d. Aug. 21 1885

Grave 3

Bennett, Hurley

Wife Ann b. Nov. 15, 1818 d. Oct. 25, 1897. Footstone

Grave 4

Bennett Hurley, b. March 13, 1820 d. Aug. 23, 1860. Footstone

Grave 5

Raymond Josiah

Wife Sarah, d. June 14, 1882, aged 99y. 11mo. 4 dys. Stone broken. Footstone

Grave 6

Raymond Josiah, died July 14, 1860, aged 70 years 5 mos. 15 days. Veteran of war of 1812.

Footstone.

Grave 7

Bowne John M., b. June 30, 1841, d. Jan. 13 1900. Masonic Emblem. Stone broken. Footstone

Grave 8

Bowne Edward, d. Sept. 5, 1868, aged 36 y. 8 m. 1d. Stone off base. Footstone

Grave 9

Bowne Mary, d. Sept. 10, 1867 Stone broken. [Martin's 1915 listing says 65y. 7m. 26d.] On same base with William Bowne. Footstone

Grave 10

Bowne William, d. Sept. 10, 1868 Stone broken. [Martins 1915 listing says 71y. 5m. 7d.] On same base with Mary Bowne Grave 9. Footstone.

Grave 11

Small Stone [probably a child] marked "N.J.M."

Grave 12

Small Stone [probably a child] marked " W.H.M."

Grave 13

Small Stone [probably a child] marked "J.M."

Grave 14

Marks Andrew, d. June 28, 1876, aged 92 y. 8 mos. 17 dys.

Grave 15

Marks Andrew

Wife Lydia, d. Nov. 28, 1871 aged 79y. 10m.

Grave 16

Page Samuel

Wife Elizabeth, d. July 1, 1871, aged 89y. 8m. 9d. Stone broken and on ground.
Footstone marked E.P. MCHA Amor Cook Note book Nee Van Note daughter of Levi.

Grave 17

Page Eratus

Page Andrew, son of Erastus and Patience, d. Aug 18, 1870, aged 23 y. 6m. 2d. Stone broken and lying flat on ground. Foot stone marked A.P.

Grave 18

Page Erastus, d. Aug. 21 1855. Stone broken in four pieces and lying flat on ground. [Martin 1915 listing says 39y. 1 mo. 15d]

Grave 19

Van Dusen Abraham D., b. July 22, 1822, d Sept. 23, 1887. Private Co K 29th N.J.V. Footstone. Civil War Vet.

Grave 20

VanDusen Abraham D

Wife Mary E., d June 25, 1865, aged 25y. 3m. Footstone.

Grave 21

Van Dusen Abraham D

Son Abraham D., d. June 14, 1865, aged 2y. 5m. 14d.

Grave 22

Riddle Henry, d. Oct 13, 1871, aged 71y. 7m. 17d. Footstone section C.

Grave 23

Riddle, Henry

Wife Charity, d. Mar. 8, 1870, aged 68y. 6m. 4d. Stone broken. Footstone in section C.

Grave 24

Riddle, Henry

Son, David, d. Apr. 20, 1878, aged 14y. 11m. 12d.

AREA C

Grave 1

Conover, Cornelius V

Wife Catherine E Hulett, b. Sept. 22, 1832, d. Mar. 28, 1879. Stone marked "Mother".
Footstone marked C. E. C.

Grave 2

Hulett, Samuel, d. May 24, 1860, aged 86y. 11m. 23d. Footstone marked S.H.

Grave 3

Hulett, S, d Oct 31, 1887 aged 65y.26d. Three circles inter twined with initials F.L.T. Small Square Stone about 6 inches square and 8 inches high.

Grave 4

Hulett, Samuel

Wife Ezediah, d. Apr. 15, 1857, aged 67y. 7m. 28d. Footstone E.H.

AREA D

Grave 1

Deteriorated wooden slab. Probably either E.H. or R.H listed by Ann P Miles in 1959.

Grave 2

Deteriorated wooden slab. Probably either E.H. or R.H. listed by Ann P Miles in 1959.

Grave 3

Fieldstone chiseled and footstone. "C. + I".

Grave 4

Fieldstone chiseled with footstone. "C.A.?"

Grave 5

Fieldstone chiseled with footstone. "C. + I."

Grave 6

Fieldstone chiseled with footstone. "M. + I."

Grave 7

Fieldstone with footstone [chiseled?] about 5 or 6 ft. between stones along side of grave 8.

Grave 8

Field stone chiseled with footstone. "B.+ I.". about 6 or 7 ft between stones

Grave 9

Fieldstone with footstone [chiseled?]

Grave 10

This stone lying flat on the ground off its base, with three names on it but no relationships

Partrick Lozado G., died Aug. 19, 1875 age 55y.

Partrick, Lydia, d. Feb. 17, 1888, aged 61y. 1m. 9d.

Partrick William B, d. June 12, 1876 aged 25y. 7 m. 18d.

Grave 11

The Base for this stone is here. In the 1980's this stone was still present for Nancy Arrence. [Data from JCD Van Note Records]

Arrence, William

Wife Nancy, d. Sept. 21, 1864, aged 60 y. 9m. 21d. [Daughter of Daniel Van Note and Mary Hannah Burdge {Will Bk. C pg 295 Mon. Co. NJ}]

Grave 12

Partrick James, d Aug. 6, 1870, aged 73y. 6m. 16d. Stone broken lying flat on ground off base with footstone marked J.P.

Grave 13

Partrick L. G.

Daughter Sallie, daughter of L.G. and Lydia, d. Sept. 23, 1868 aged 1y. 2m. 25d.
Footstone marked S.P.

AREA E

Only Half of an old base [other half in section I] for a sign or something else found in this area

AREA FGrave 1

Hayes John,

Son Nelson, son of John and Eliza Hayes d. Nov. 16, 1872 age 16y. 9mo. 10d. Footstone.

Grave 2

Havens Samuel b. Nov. 11, 1852, d. July 27, 1912. Footstone.

Grave 3

Havens, Catherin M. b. June 27, 1847, d. Feb. 24, 1931

Grave 4

Hayes, Alexander, b. May 3, 1861, d. Aug. 1, 1920. Footstone.

Grave 5

Montgomery, James, d. Aug. 20, 1869, age 62y. 3m.

Grave 6

Montgomery James

Wife Margaret, d. Apr. 20, 1872, aged 72y. 1m.

Grave 7

Grave now three bricks for base Unknown

AREA GGrave 1

Johnson, James E, b. Feb 23, 1764, d. May 26, 1831 age 67y. 3m. 3d. Footstone

Grave 2

Johnson James

Wife Rachel, d. Apr. 5, 1857 aged 75y. 6m. 11d. Footstone.

Grave 3

Maxson, Samuel, b. July 23, 1808, d. Aug 3, 1826 age 18y. 11d. Footstone

Grave 4

Fieldstone Head and foot no chiseling visible appears to be child. [See grave H9]

Grave 5

Fieldstone no chiseling visible. [See grave H9]

Grave 6

Field stone Head and foot no chiseling visible appears to be child.

Grave 7

Field Stone small no chiseling visible

Grave 8

Field stone no chiseling visible.

AREA H**Grave 1**

Home made stone chiseled Matt (hs) d. May 25, 1806. [This is Mary Brewer Daughter of Elazerus and Francis (Morris) Brewer and 1st wife of William Matthews{Stillwell4-51} She also shows in bible record of William C Lewis and Abigail Morris Lewis Lebanon Ohio, and called Mary Mathner in Amor Cook Notebook at MCHA {Steen Coll.}]

Grave 2

Jones Elisha, d. Oct. 8, 1862, aged 75y. 1m. 16d. Footstone marked E.J.

Grave 3

Jones Elisha

Wife Anne, d. Nov. 19, 1865, age 74y. 10m. 19d. Footstone marked A.J. Stone flat on

Ground.

Grave 4

Fieldstone chiseled "E.M." Maybe second wife of William Matthews.

Grave 5

Fieldstone with footstone chiseled "WM". The last leg of the W is the first leg of the M. [This, we think, to be William Matthews who died Aug. 19, 1834 according to bible record cited for his wife Mary]

Grave 6

Fieldstone chiseled "M ?" [Graves H1, H4, H5, H6, H9, G4 and G5 may all be for the same family of Matthews]

Grave 7

Fieldstone chiseled "CW"

Grave 8

Fieldstone no chiseling visible.

Grave 9

Fieldstone chiseled "WMENTM" This fieldstone is at the base of a tree with a small fieldstone about four foot from it and along side of it on the left are two small graves G4 and G5 which may mean its for three children WM, EM and TM

Grave 10

Small fieldstone no chiseling visible

Grave 11

Small fieldstone no chiseling visible

Grave 12

Small fieldstone no chiseling visible

AREA I

One half of an old base, the other half in section E, for a sign or something else and a Brewer's Cemetery sign.

Grave 1

Headstone part broke off and missing the age 19y. 1m. 9d. visible, footstone marked M.E.W. Martin in 1915 said stone in cemetery Warden, Mary E., daughter of Benjamin and Ann d. Apr. 4 1864 aged 19y 1m 8d.

Grave 2

Monument made of concrete inscribed on base "Erected by Geo. E. Smith 1905"

Levi Woolley, b. Dec. 18, 1811, d. July 24, 1892 "Father"

Hannah, b. Apr. 4, 1819, d. Nov. 13, 1892 "Mother"

Grave 3

Headstone broken no footstone, white Marble. Martin lists a Woolley, Joseph B., d. Oct. 31, 1844, aged 39y. 4m. 22d. No stone was found in the cemetery for him, therefore possible this was the grave.

AREA K**Grave 1**

Hayes Eliza, wife of John, b. Feb. 13, 1825, d. Jan. 8, 1882

Grave 2

Hayes, John, d. Sept. 25, 1901, aged 83y.

Grave 3

This stone leaning against a tree very deteriorated shows " John A & -----Brewer who Departed -
--- ----- Sept 21 AD 18—aged 1(6) years----d. Martin in 1915 listed Brewer, Lydia, dau. of John and
Constant. D. Sept. 10, 1810, aged 16y. 21d. This appears to be that stone and may belong on grave K 9

Grave 4

Brewer, George d. Mar. 23, 1851 aged 80y. 1m. 8days.

Grave 5

Parkes, John

Wife Jemima B., d. June 9, 1864, aged 61y. 8m. 28d.

Grave 6

Parkes, John, d. Sept. 10, 1861, age 79y. 9m. 3d.

Grave 7

Corlies, William,

Relict Hester, b. Jan. 28, 1782, d. Aug. 28, 1874 "Our Mother" This stone is leading on
part of base with other part of base in front.

Grave 8

Brewer, John E. & Constant,

Son Robert, d. Aug. 29, 1825 aged 26y. 5m. 18d.

Grave 9

Mound Grave with footstone unmarked This may be Grave for K3

Grave 10

Brewer, John E., d. Feb. 6, 1837, aged 82y. 4m. 22d. Veterans List lists as veteran, but no war
cited, implied Rev. War Vet.

Grave 11

Brewer John C,

Wife Constant, d. Sept. 17, 1845, aged 84y. 7m. 22d.

Grave 12

Brewer, John & Constant,

Son William H, d. Dec. 22, 1841 age 55y. 3m. 21d.

Grave 13

Brewer Samuel & Margaret,

Daughter Cornelia Ann, d. Dec. 29, 1845 age 2m.

Grave 14

Brewer Samuel & Margaret,

Daughter Lydia, d. Dec. 22, 1841, age 11d.

Grave 15

Brewer William & Harriet,

Daughter Rachel Ann, d. Feb. 12, 1862, age 10y 11m. 21d. Footstone R.A.B.

Daughter Ellen, d. Oct 26, 1862, age 15y. 1m. 5d

This monument for both daughters one has name on one side the other name on another and rose
Buds on the third, and both names on the fourth side.

Grave 16

Broken Headstone one piece in ground and footstone marked E.H. in section O (also called Grave
1 in section O. Martin lists in 1915 Herbert, Elizabeth, wife of Robert, d. Sept 5, 1886, aged 81y. 4m. 21d.

Grave 17

Brown, Ezekiel,

Wife Caroline, d. Jan. 29, 1854, age 30y. 8m. 22d. daughter of Robert and Elizabeth

Herbert.

Grave 18

Lippincott, Meribah, d. Aug. 28, 1849 age 56y. 15d.

Grave 19

Wentzel, Constant, d. Feb. 12, 1820, aged 3y. 11m. 12d.

Grave 20

Grave marked with deteriorated wooden slab, found what appears to be "879" on it. Martin in 1915 listed a Hardy, Rebecca 1879 (on Wooden Slab)

Grave 21

Warden William & Mary,
Son Jeremiah, d. May 21, 1825 aged 2y 21d.

Grave 22

Warden William & Mary
Son James C, d. Apr. 7, 1835 age 14y. 1m. 28d.

Grave 23

Warden William, died Mar. 26, 1872, age 86y. om. 23d.

Grave 24

Warden William,
Wife Mary d. July 18, 1878, age 86y. 6m. 0d.

Grave 25

Lippincott, James M. 1841-1916 Priv. Co. k. 29 N.J.V. Marked F.L.T. and I.O.O.R. monument has plate on Treeman Thomson Monument Freehold NJ. Veterans List shows as Civil war Vet.

Grave 26

Lippincott, Samuel & Rachel
Daughter Emily, b. Apr. 29, 1828, d. Jan. 18, 1904.

Grave 27

Lippincott, Rachel, died Sept. 13, 1884, aged 80y. 9m. 27d. Footstone R.L.

Grave 28

Lippincott, Samuel, d. Aug. 15, 1857, aged 61y. 9m. 24d. Footstone S.L.

Grave 29

Lippincott, Samuel & Rachel,
Son John William d. July 10, 1830 aged 5m. 30d. Footstone J.W.L.

Grave 30

Grave marked with bottom of deteriorated wooden slab unknown.

AREA L

Grave 1

Warden, Elizabeth

Grave 2

Wardell, Samuel, b. Feb. 14, 1770, d. June 27, 1853 age 82y. 4m. 13d. footstone S.W.

Grave 3

Fieldstone on grave unknown

Grave 4

Grave Area P grave 4 but stone in area L grave 4 marked "K"

Grave 5

Fielder, John, Co K 29th N.J. Inf. Small military stone with shield. Two stones behind one appears to be part of a footstone from somewhere the other appears to have writing on and chisel marks on edge. Listed Veterans list as Feilder.

Grave 6

Fieldstone no markings visible maybe grave.

AREA M

Grave 1

Fieldstone no markings visible

Grave 2

Gifford, John d. Sept. 2, 1828 aged 68y. 11m. 2d.

Grave 3

Gifford, Faithfull, d. July 6, 1841, aged 84y. 5m. 14d.

Grave 4

Grave piece of slate each end of grave unknown.

Grave 5

Wooden Slab badly deteriorated unreadable

Grave 6

Wooden slab badly deteriorated unreadable.

Grave 7

Davis, John, d. Mar 17, 1859 aged 51y. 6m.

Grave 8

Grave no stone shows unknown

Grave 9

Grave no stone shows unknown

Grave 10

Morris, Richard,
Wife Elcy, d. June 19, 1844, aged 44y. 2m. 27d.

Grave 11

Cook, Thomas, b. Feb. 12, 1792, d. Sept. 14, 1821

Grave 12

Cook, Amor,
Consort Deborah, b. Mar. 10, 1765, d. Apr. 6. 1836

Grave 13

Grave no stone shows unknown

Grave 14

Grave no stone shows unknown

Grave 15

Grave fieldstone no markings.

AREA N**Grave 1**

Joseph L. Burdge
Wife Mary, d. Mar. 22, 1902, aged 77y. 4m. 11d.

Grave 2

Headstone only a few pieces, footstone marked J.L.B. Martin in 1915 listed Burdge, Joseph L., d. Mar 26, 1879, aged 58y. 9m. 1d.

Grave 3

Morton, Samuel
Son Morton, Frederick L, son of Samuel and Sarah E, d. Nov. 12, 1864, aged 6y. 10m.

25d.

AREA O**Grave 1**

Broken Headstone one piece in ground in Section k and footstone marked E.H. in section O (also called Grave 16 in section K. Martin lists in 1915 Herbert, Elizabeth, wife of Robert, d. Sept 5, 1886, aged 81y. 4m. 21d.

Grave 2

Cooper Joseph G and Sarah E,
Son Charles born 1861 died 1878

Grave 3

Mound Grave unmarked

Grave 4

Mound Grave unmarked

Grave 5

Wainright, Josiah, August 2, 1809 died Nov. 6, 1866. Stone engraved by W. C. Bray Manasquan.

Grave 6

Wainright, Josiah,

Wife Fanny, b. Mar. 23, 1808, d. Mar. 15, 1881. Stone engraved by W.C. Bray

Manasquan.

Grave 7

Wainright Josiah & Fanny

Daughter Lafetra, Deborah C. b. Feb. 15, 1837, d. Sept. 30, 1869. Stone engraved by

W.C. Bray Manasquan.

Grave 8

Megill, James E,

Wife Catherine b. Sept. 14, 1826, D. Feb. 27, 1882

Grave 9

Mound Grave unmarked

Grave 10

Mound Grave unmarked

Grave 11

Mound Grave unmarked

AREA PGrave 1

Megill, William & Mary

Son Halstead W died Mar. 1, 1864 aged 35y 9m. 7d.

Grave 2

Megill, William,

Widow Mary, d. May 26, 1884, aged 88y. 11m. 12d.

Grave 3

Megill, William, d. Aug. 29, 1861, aged 70y. 4m. 23d.

Grave 4

Mound Grave Unmarked in this section but has stone in section L marked "WA"

Grave 5

Mound Grave unmarked

Grave 6

Hankins, Isaiah 1839-1883

Grave 7

Stokey John C

Wife Emeline d. Mar. 13, 1873 aged 35y. 0m. 21d. Footmarked marked E.S.

Grave 8

Stokey, G.H. Cor'p Co a. 14th Regt. N.J. Inf. Civil War. Veterans List shows died 12/13/62

Grave 9

Elmer Samuel,

Wife Rachel, D. Dec. 2, 1854, aged 27y. 10m. 16d. footstone marked R.E.

Grave 10

Stokey, Fredrick, b. Jan. 13, 1838, d. Jan. 12, 1887. Footstone F.S.

Wife Elma, b. July 8, 1842, d. Aug 18, 1885. Footstone E.S.

Son Clarence, b. Aug. 16, 1880, d. Feb. 10, 1882. Footstone C.S.

Stokey John E, b. Mar. 7, 1870, d. Oct. 31 1870 (Son?) No footstone but deep hollow to left of stone.

Grave 11

Elmer, Amos

Wife Elizabeth, d. Oct. 31, 1855, aged 99y. 9m. 16d.

AREAQGrave 1

Mound Grave unmarked

Grave 2

Grave marked with deteriorated wood slab.

Grave 3

Megill Joseph & Catherine,
Daughter Catherine d. July 18, 1851, aged 21y. 6m. 20d.. Footmarker C.M.

Grave 4

Megill Thomas I & Sarah,
Son Richard, d. May 19, 1857, aged 3m. 27d. Footstone R.M.

Grave 5

Megill Joseph,
Wife Sarah, d Jan. 10, 1821, aged 29 y. 8m. 3d.

Grave 6

Megill Joseph,
Wife Catherine, d. July 21, 1863, aged 63y. 6m. 2d.

Grave 7

Megill Joseph, d. Oct. 13, 1867 aged 81y. 6m. 21d.

Grave 8

Grave marked with deteriorated wood slab.

Grave 9

Field stone headstone and footstone no visible marks.

Other records

Number 1

Graves mentioned by Martin in 1915 and others no longer found marked.

Hayes Ollie, 2 months [Last mentioned 1959]

Gromaire, Jean, d. Apr. 2, 1885, aged 61y.7m.[Last mentioned in 1946]

Layton, Deborah E., dau. of Wm.H. and Elizabeth d Apr. 4, 1871, aged 1y. 2m. 11d [Lst mentiod in 1915]

Number 2

Micro film on St. Peters Mission at Allaire from Monmouth County Historical Association files.

Fredrick Stokey (no Age) Allaire died January 13 1887 railroad accident. He was buried Saturday afternoon January 15th at Brewer's [Grave P-10]

Mrs. Elma Stokey 44yr of Allaire died 18 August 1885 Childbirth. She was buried Friday Afternoon August 21 1885 at Brewer's [Grave P-10]

Clarence Stokey 1y. 5m. 25d. died feb. 10, 1882 pneumonia. He was buried Monday afternoon 13 Feb. at Brewer's [Grave P-10]

Frederich Stokey Senr. 74th yr. Died at Allaire 11 feb. 1882 of gangrene. Buried Monday afternoon feb. 13th 1882 at Brewer's. No stone now known to identify this grave.

Samuel Sidney Burdge, 7y. 2m. Middletown Township N.Y. died May 14th 1882 of measles. He was buried Wednesday morning May 17th at Brewer's. No stone now known to mark this grave.

Hannah Grant 66yrs old Allaire died Dec. 22, 1883 of congestive chills. She was buried Wednesday morning Dec. 26th at Brewer's. No stone known to mark this grave.

Eliza Hayes 56y. 10m. 24d. died Jan. 8, 1882 of apoplexy. Buried Tues day Morning 10 Jan. at Brewer's [Grave K1]

Number 3

Coroner Inquest Monmouth county Archives Files.

Inquest June 30 1894: Revelle, Arthur, address; 528 County Street Portsmouth Va.

William Van Note an employee of Central RR of New Jersey, a trackwalker, on Saturday morning, June 30, 1894 at 6AM, found a body at Hendrickson's Switch about 2 ½ miles from Farmingdale N.J. The body was about 25 years old white.

William Van Note went to Jesse's Woolleys, a farmer at Squankum, father's house and had him stay with the body, then notified George W Fielder Jp. He called for an inquest and Notified the Coroner. The body was buried at Brewer's June 30 1894.

On July 6, 1894 the body was disinterred so that Arthurs brother W. Reville could view and identify the body. He did and the body was reinterred. [No stone now known to identify this Grave.

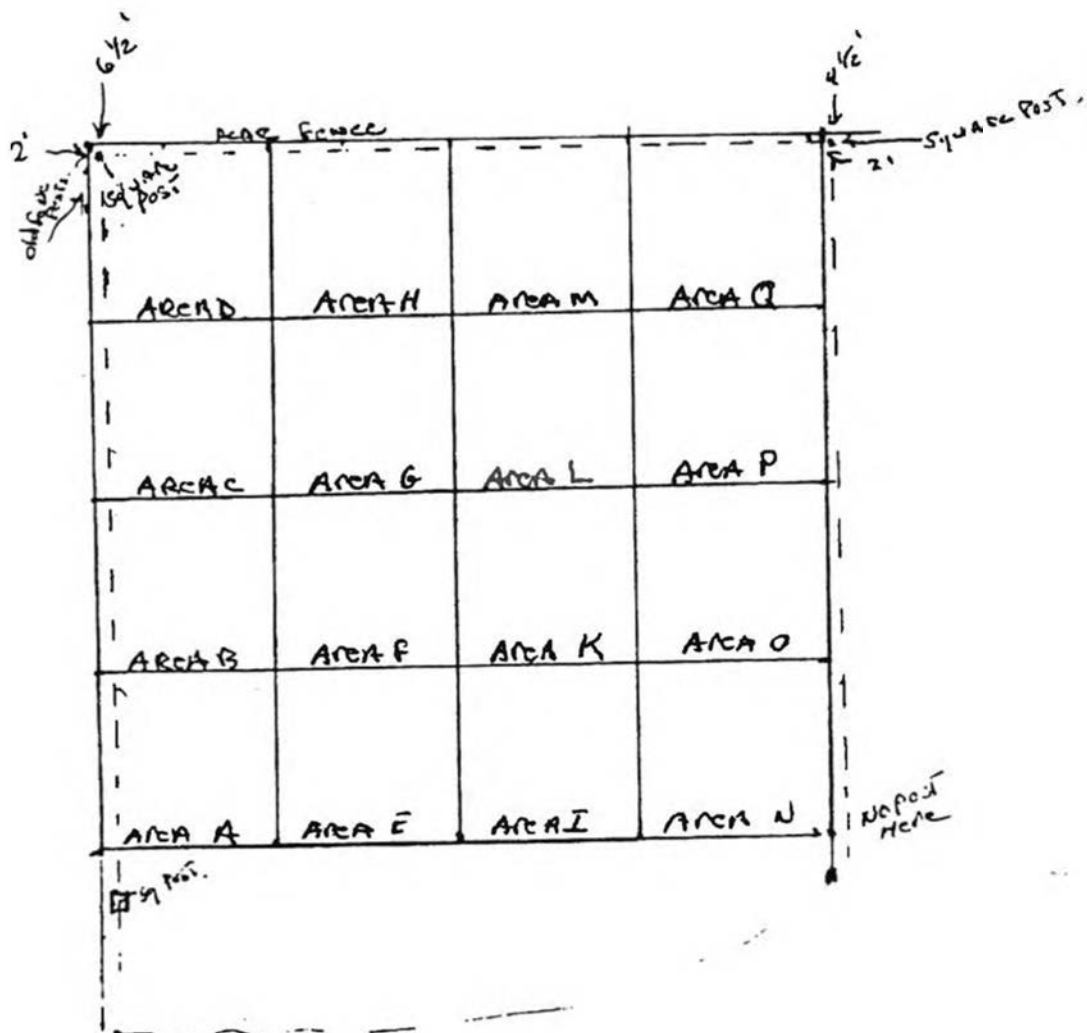

Brewer's cemetery

RT 524

SQUANKUM N. J.

ws=wooden slab T=Tree M=mound H=Hollow PS=Footstone

[illegible]

AREA B

NO Grass Found.
AREA A

Brewers

	FS 12	FS 9		
FS 12				FS FS
10 11				7 8
			FS FS	
			5 6	
T 1 2		FS FS 3 4		
			T	
	M	M		
	M			
FS 4 3 2	FS 2	M M	1	
		FS FS 823 822		

AREA D

AREA C

Brewers.

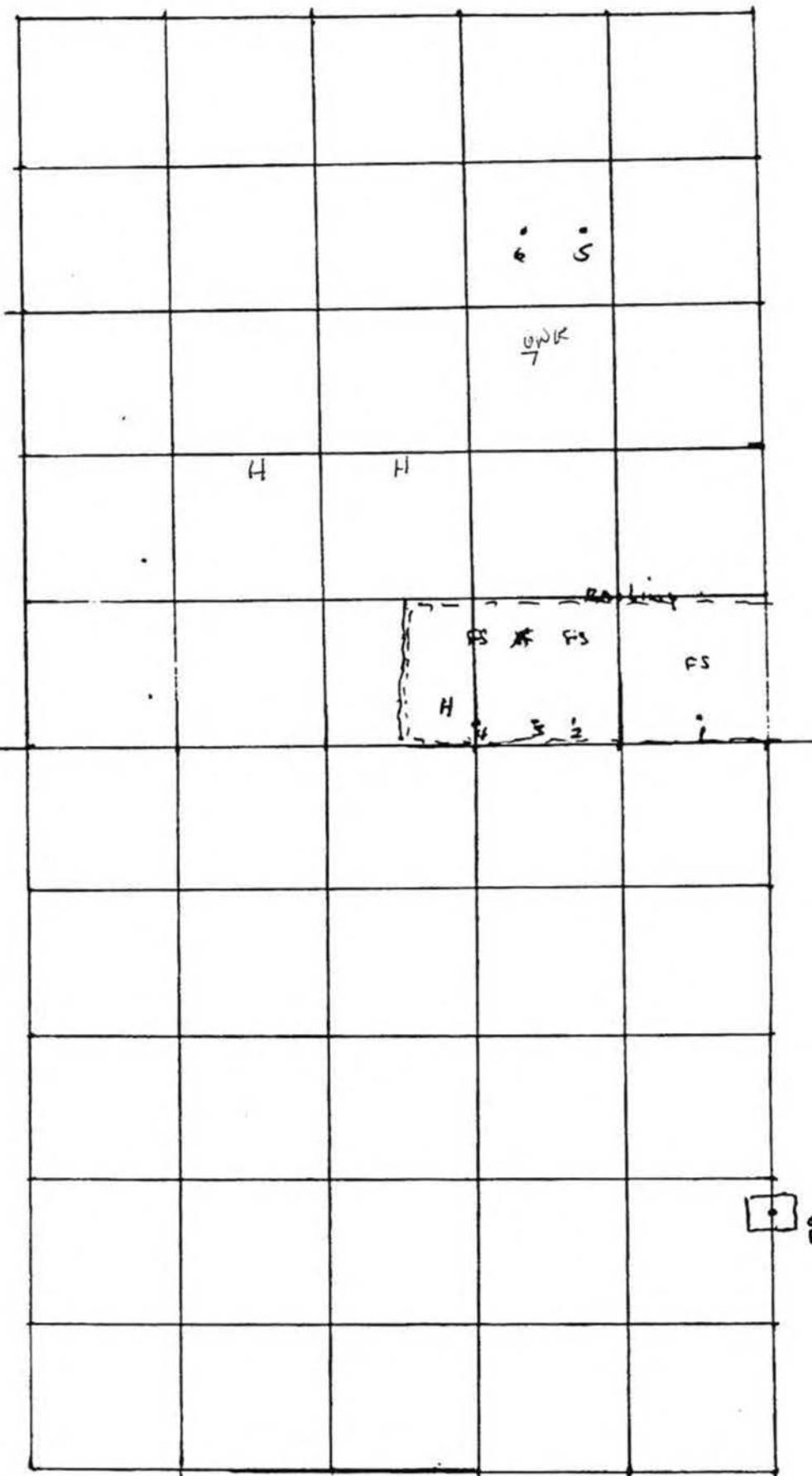

AREA F

AREA E

Brewers

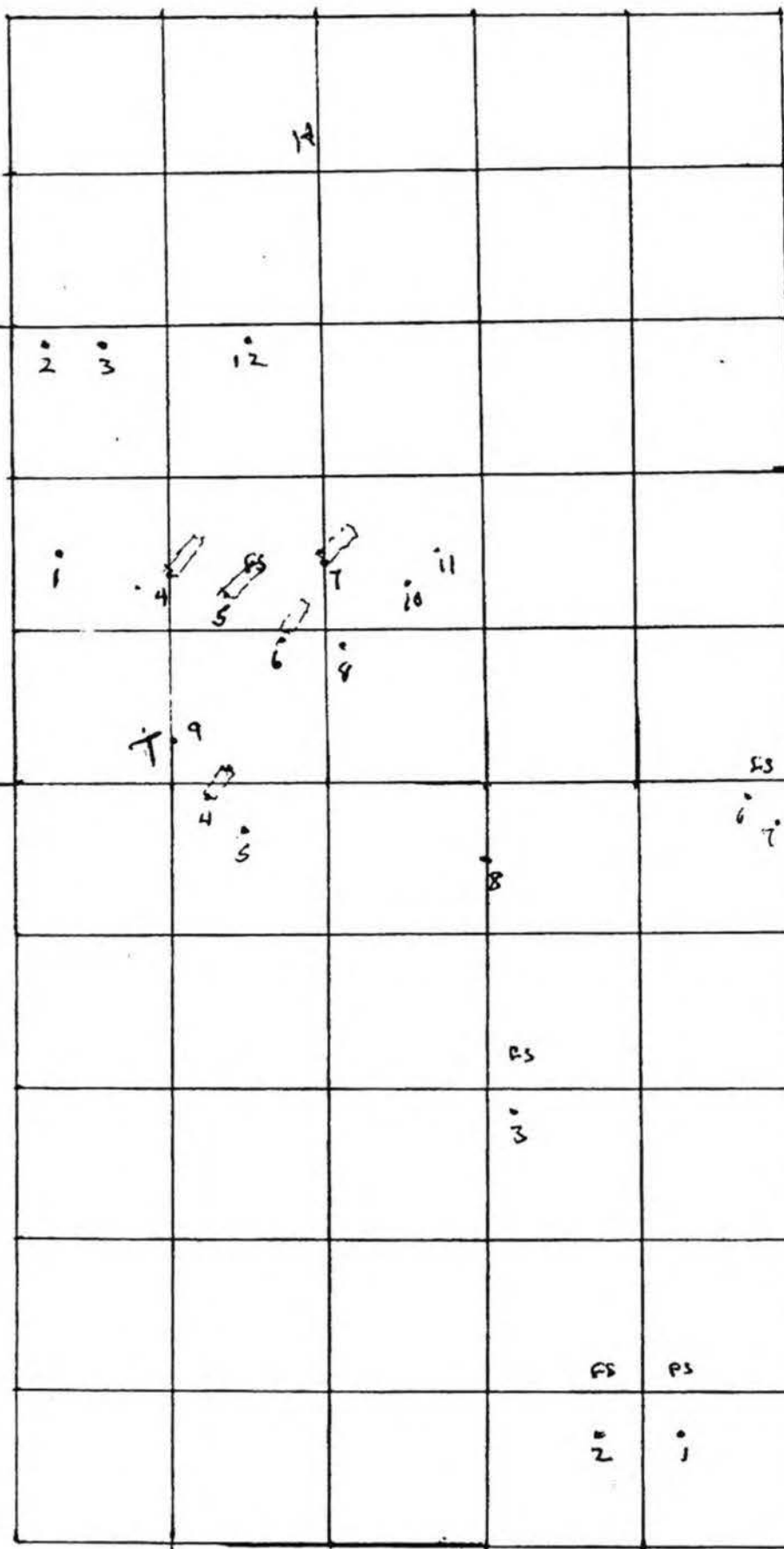

AREA

H

PS

PS

3

PS

PS

2

1

AREA

G

Brewers-

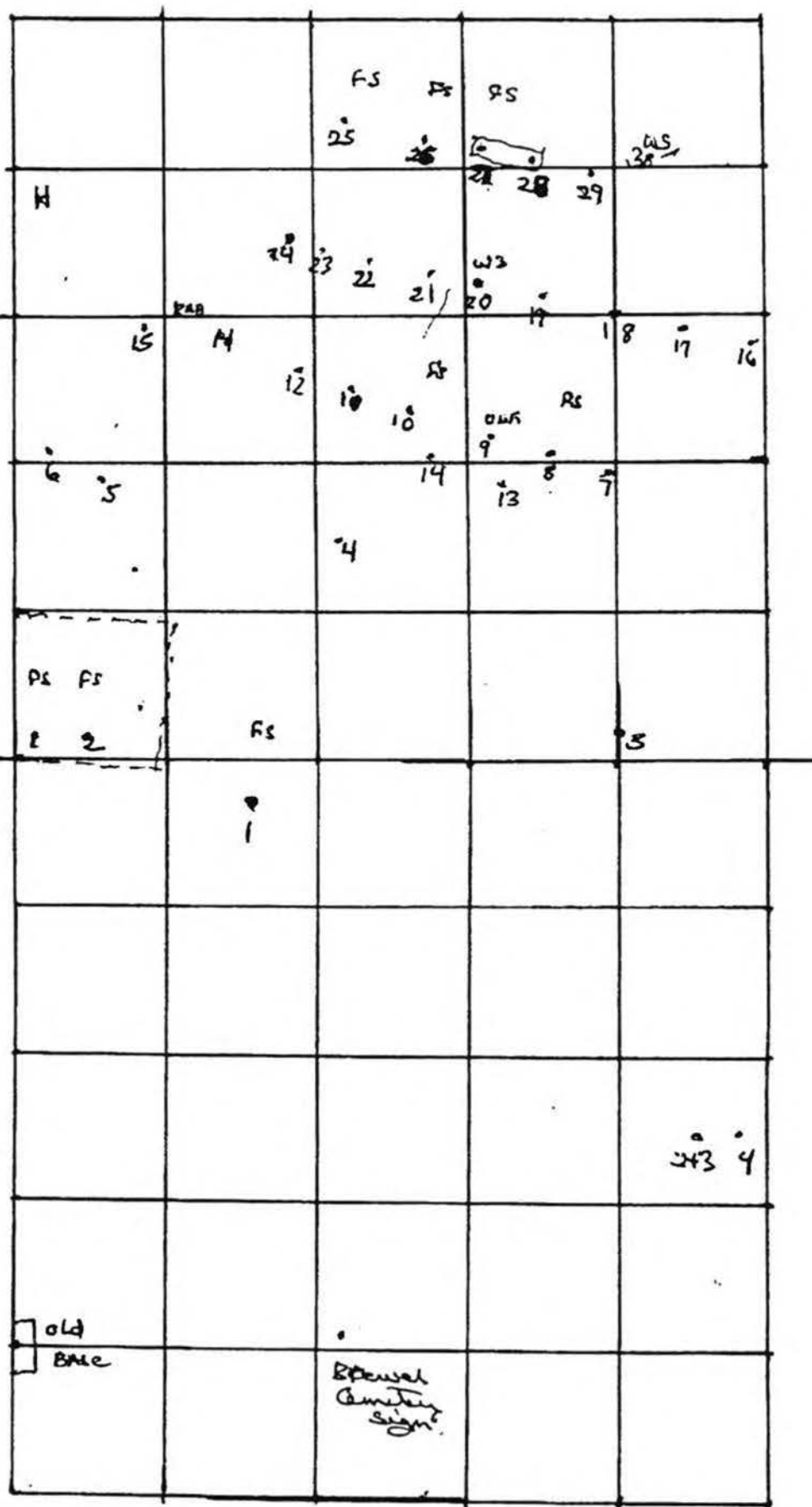

Brewers.

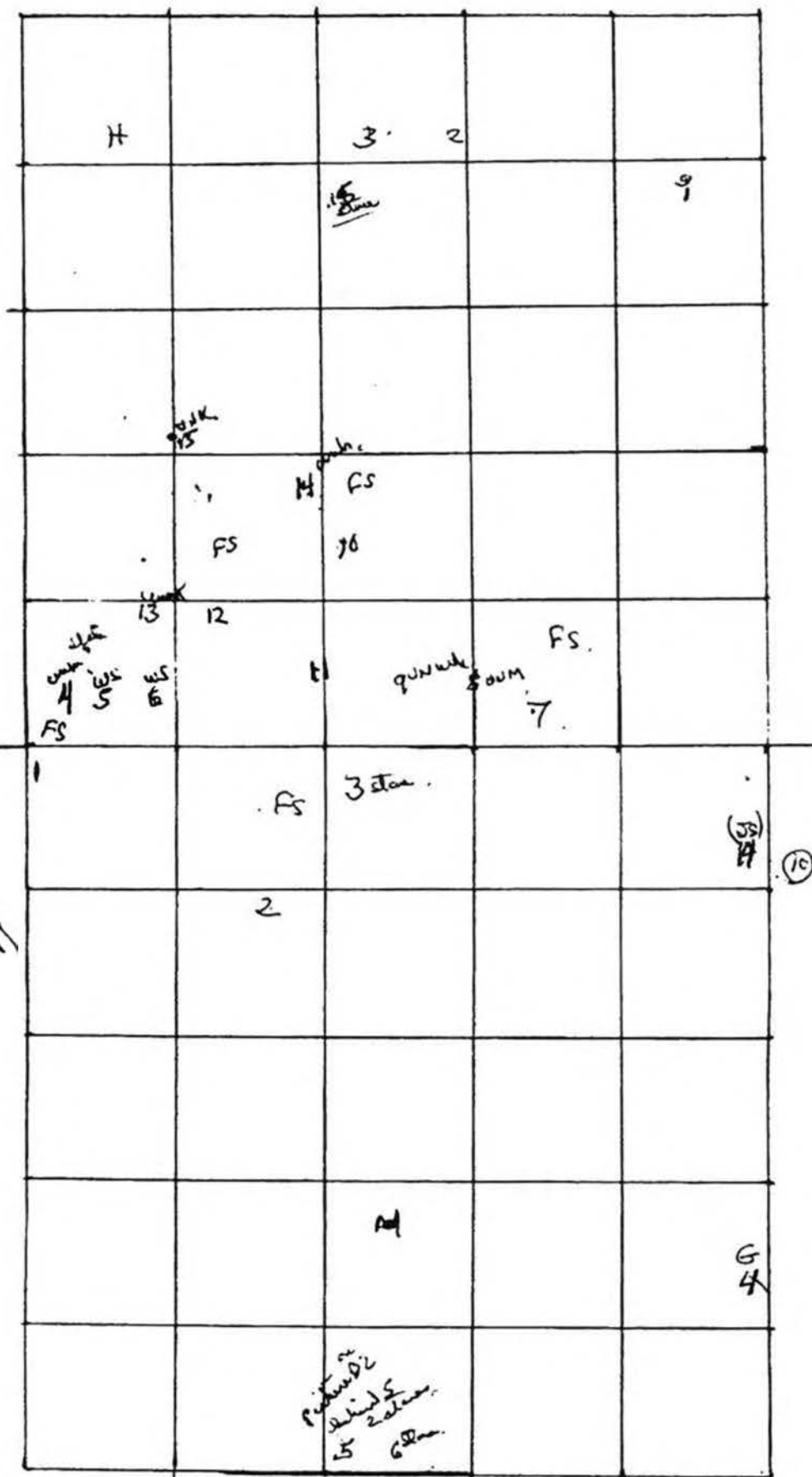

AREA M

(L3)
rock
picture
identity

A

AREA L

Brewer's

Brewers

A hand-drawn map of "Area O" featuring a 6x6 grid. The top edge is labeled "FS FS FS FS". The left side has "AREA O" written vertically. The bottom edge is labeled "Brewers.". Inside the grid:

- Row 1: Column 3 has "3"; Column 4 has "7"; Column 5 has "H.W.K. 9 B-"; Column 6 has "M".
- Row 2: Column 2 has "2 · T"; Column 3 has "H"; Column 5 has "M".
- Row 3: Column 1 has "FS EH." and "stroke 1"; Column 2 has "H"; Column 3 has "3 U.K."; Column 4 has "4 U.K. H"; Column 5 has "H".
- Row 4: Column 2 has "H"; Column 3 has "H"; Column 5 has "BIG HELLO H".
- Row 5: Column 1 has "FS"; Column 2 has "FS"; Column 3 has "H"; Column 4 has "H"; Column 6 has "3".
- Row 6: Column 1 has "1"; Column 2 has "2".

Other markings include "AREA O" on the left and "Brewers." at the bottom.

42
4a
32

AREA Q

(H/Es)

AREA P

				FS FS FS	
9 th Jan.	8 th Jan.	H	7 6 5		
			M M M M	4 3 2 nd	
			look		
		H FS			
		IT M			
		H	H M		
	FS				FS
	T		M		9
4 th Jan.	3 rd Jan.		M H	FS FS FS	
				1 2 3	
H		H M		H H	
		FS FS FS		FS.	

Brewers.